



Product Familiarization & Installation Guide

Abseco[®] AFi Series Bell Switch
AFI-2M0S1B

*Revision No.: Initial Issue
Dated: Aug 01, 2021
Printed in India*

Abseco International Pvt. Ltd.



Copyright Information

Copyright ©2021 by Abseco International Pvt. Ltd.

All rights reserved. No part of this publication or design may be reproduced, distributed, or transmitted in any form or by any means, including photocopying, recording, or other electronic or mechanical methods, without the prior permission of the publisher.

Notice

The only warranties for Abseco products and services are set forth in the express warranty statements accompanying such products and services. Nothing herein should be construed as constituting an additional warranty. Abseco shall not be liable for technical or editorial errors or omissions contained herein. The Abseco International Pvt. Ltd shall not be liable for incidental or consequential damages in connection with, or arising out of the furnishing, performance, or use of this document and the program material which it describes.

Trademarks

- ABSECO, the Abseco logo, and Afi Series are property of Abseco International Pvt. Ltd.
- The Works with Google Assistant logo is a trademark of the Google Inc.
- Amazon Alexa, Works with Amazon Alexa are registered trademarks of Amazon.com, Inc.
- The Bluetooth word mark and logos are owned by the Bluetooth SIG, Inc. and any use of such marks by Abseco is with approval.
- Other brands and their products are trademarks or registered trademarks of their respective holders.
- The copyrights to certain photos within this document are retained by the original owners.

Warranty

All electronic devices are warranted against manufacturing defects for two years from the date of purchase. In the event of defects, Abseco will repair or, at its discretion, replace the warranted product if delivered to an Abseco authorized dealer along with a duly stamped guarantee card and sales receipt that shows the date of purchase along with the serial no. of the product. This warranty excludes defects due to abnormal load, abuse or failure to use the product in accordance with the instructions. Abseco shall not be liable for any other damages, whether incidental, consequential or otherwise.

Introduction

Abseco® AFI Series Bell Switch module is an innovative, futuristic and affordable smart automation device which give users total control of their lights, appliances and electrical outlets through various control methods such as smartphones, voice assistants, network profiles, and cloud services such as IFTTT.

Our smart-touch solution provides a comprehensive automated home or business electrical control ecosystem, offering users unparalleled levels of control and visibility over their home or business lighting, heating, and cooling systems, all delivered in one affordable, accessible, and easy-to-use package.

Safety Information

Always follow all basic electrical/electronic safety precautions when using this smart switch (product) to prevent risk of injury from fire or electric shock, or product damage.

- Read and understand all guidelines provided in this document regarding safety, warranty, installation, and use before installation/use of the product.
- All instructions and safety precautions detailed in this guide must be strictly followed. Observe all warnings and instructions marked on the product.
- If the instructions and safety precautions detailed in this manual are not correctly followed, Abseco International Pvt. Ltd. cannot be held responsible for any personnel injury and/or equipment/product damage.
- To prevent electric shock, disconnect both the poles of the main supply before installing the product.
- Do not install this product where it can come in contact with water. Never do installation of the product with wet hands. Dry your hands to avoid electrical shock/injury.
- Product must be installed securely on a wall/surface without uneven gaps.
- This product is a single pole switch and disconnects only one pole when it is in OFF condition.
- Installation of the product must be performed by a qualified electrical technician.
- Product damage caused by incorrect installation or use is not covered under warranty and the related warranty claims will be rejected.
- There are no user serviceable parts inside the product. Product repair/servicing must only be carried out by a qualified service personnel authorized by the company.

Main Features

- Refined look and feel
- Made of fire resistant, safe and durable materials
- Waterproof tempered glass touch panel with advance capacitive touch technology
- Multiple colour choices to choose from to match with any room decor
- Inbuilt overload and surge protection
- Functional module design to easily replace your traditional mechanical switch
- Separate indicators for on/off status and touch switch illumination for ease of detection during night
- Simple retrofit installation; does not require special wiring

Technical Specifications

Parameter	Specification
Switch Classification	Doorbell Wall Switch
Model No.	AFI-2M0SIB
Power Supply Mode	Live Wire; Requires a Neutral Line
Rated Current	6 A
Rated Voltage and Frequency	100–250 VAC, 50–60 Hz

Parts Identification

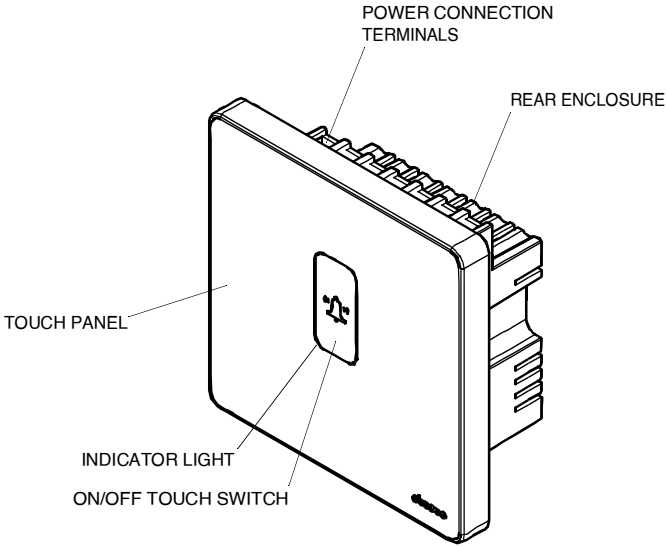

Power Connection Terminals

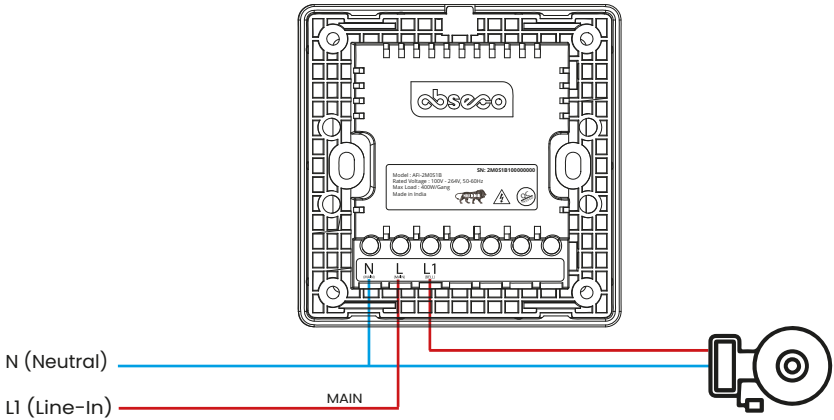

Installation Instructions

1. Connect the electrical wires to the terminals of the switch module as shown in the wiring diagram.

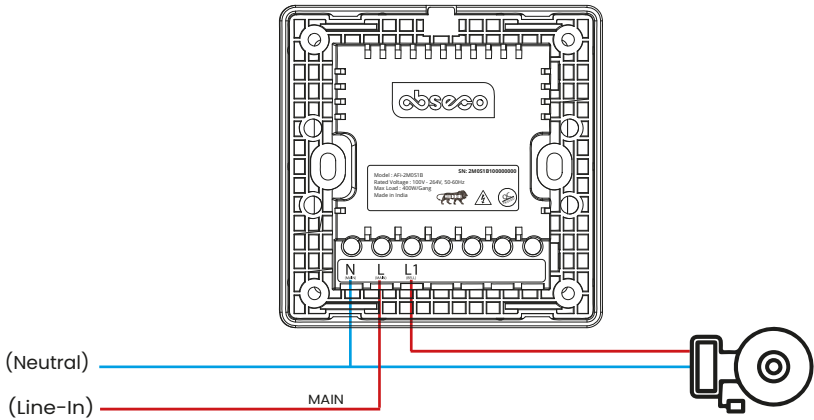

2. Insert the switch module into the switch mount box and secure with 2 screws.

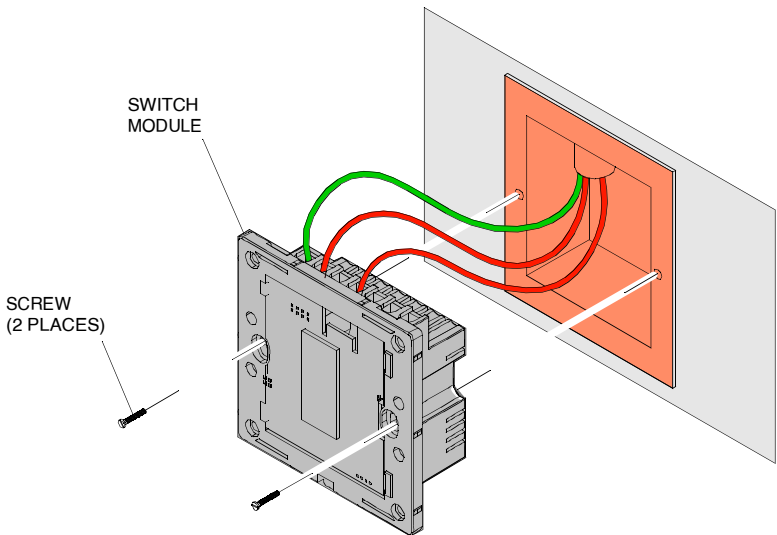

3. Align and position the front touch panel (face plate) onto the switch module.

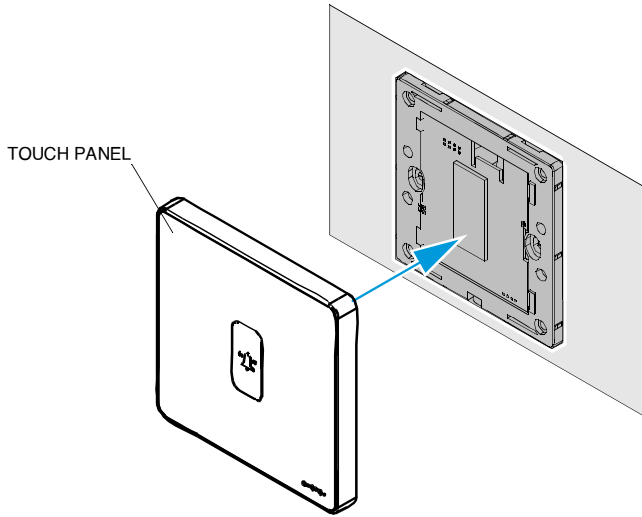

- Carefully press the touch panel by applying even force on all sides until it is seated securely on the switch module.
Make sure that the touch panel is seated correctly without any uneven gaps.

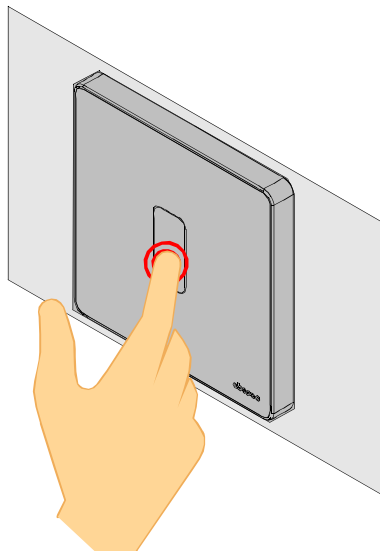

5. After installation, switch on the main electrical power supply and verify that the touch switch is working correctly.

Troubleshooting

If your bell switch is not operating correctly, perform the troubleshooting instructions given below. If problem persists, contact your Abseco dealer or local authorized Abseco service center.

FAULT	PROBABLE CAUSE	REMEDY
Not able to turn on the Bell switch (indicator light on the bell switch is OFF)	No power supply or main power supply is OFF.	Make sure that power supply is available and the main power supply is ON.
	Electrical connections to the bell switch are incorrect.	Make sure that the electrical connections to the bell switch are correct. Refer to Wiring Diagram given in Installation Instructions.
bell not ringing when bell switch is turned on (indicator light on bell switch is ON)	The electric bell is burned out.	Make sure that the bell is in working condition. If necessary, use a an electric bell that is in working condition to make sure that the fault is not due to a burned electric bell.
	Electrical connections to the bell switch are incorrect.	Make sure that the electrical connections to the bell switch are correct. Refer to Wiring Diagram given in Installation Instructions.

Additional information on this product and answers to frequently asked questions can be found at our Website.

Official Website: www.abseco.ltd
Service Email Address: care@abseco.ltd

